



2 Ash Crescent, Bishopdown Farm, Salisbury, Wiltshire, SP1 3GY

£1,100 PCM

Accommodation Comprises;

Entrance lobby with laminate flooring, sitting room with decorative fireplace with electric fire, wood laminate flooring. Kitchen/Dining Room, range of fitted units, electric oven and gas hob with extractor hood over, space for fridge and space and plumbing for w/m, door to garden.

Bedroom 1 with large airing/storage cupboard, fitted wardrobes, Bedroom 2 with fitted wardrobes. Bathroom with shower over bath, WC.

Outside; the former garage has been converted into additional accommodation incorporating a cloakroom/WC, utility where there is also space and plumbing for a w/m and an office, space for freezer. Parking for two cars to the front of the property and at the rear is an enclosed south facing garden, well stocked with a paved patio and lawned area. Summer House with power connected. Gas central heating.

WHITES
 Castle Chambers, 47 Castle Street,
 Salisbury, Wiltshire, SP1 3SP
 01722 336422
www.hwwhite.co.uk
residential-sales@hwwhite.co.uk

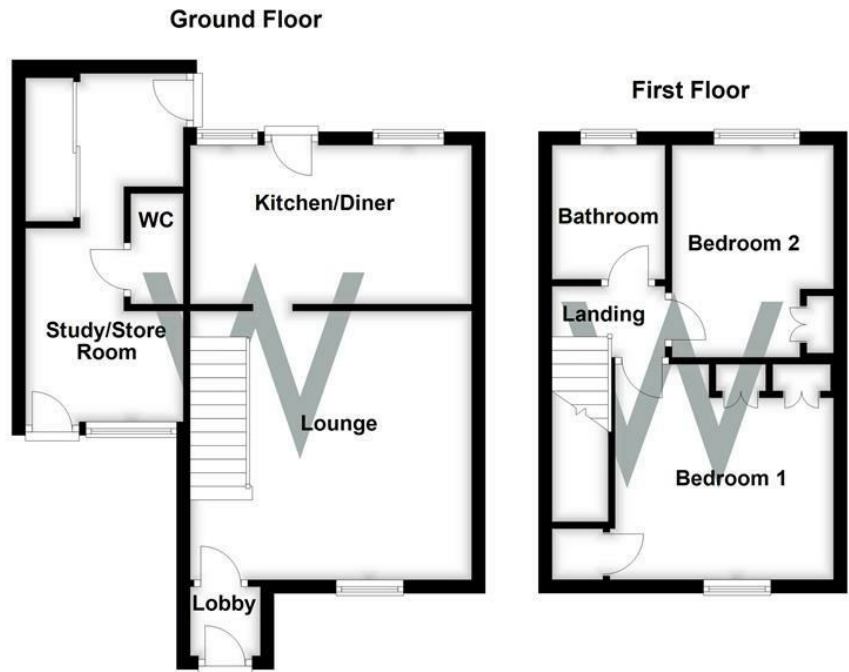

Energy Efficiency Rating		
	Current	Potential
Very energy efficient - lower running costs		
(92 plus) A		86
(81-91) B		
(69-80) C	69	
(55-68) D		
(39-54) E		
(21-38) F		
(1-20) G		
Not energy efficient - higher running costs		
England & Wales		EU Directive 2002/91/EC

